

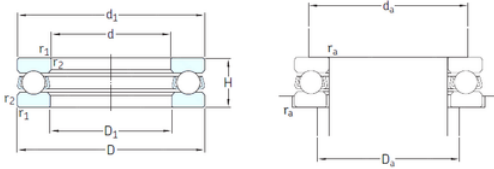

# Bearing Driveshaft do Brasil

## SKF 51152M thrust ball bearings



Bearing No. 51152M

Size	260x320x45 mm
Bore Diameter	260 mm
Outer Diameter	320 mm
Width	45 mm
d	260 mm
D	320 mm
H	45 mm
d1	317 mm
r1 min.	1,5 mm
r2 min.	1,5 mm
D1	263 mm
da min.	296 mm
Da max.	284 mm
ra max.	1,5 mm
Weight	8,1 Kg
Basic dynamic load rating (C)	238 kN
Basic static load rating (C0)	1 100 kN
Fatigue load limit (Pu)	24
Reference speed	1100 r/min
Limiting speed	1500 r/min

51152M Bearing 2D drawings and 3D CAD models