

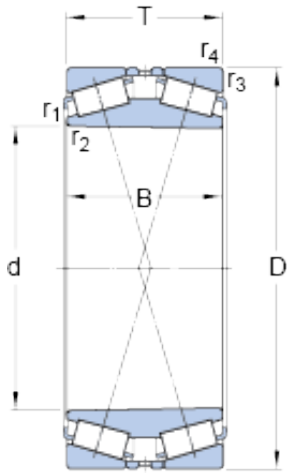

## Bearing Driveshaft do Brasil



384.175 mm x 546.1 mm x 193.675 mm SKF  
BT2B 328580/HA1 tapered roller bearings

Bearing No. BT2B 328580/HA1

BT2B 328580/HA1 Bearing 2D drawings and 3D CAD models

Size	546.1x384.175x193.675 mm
Bore Diameter	546,1 mm
Outer Diameter	384,175 mm
Width	193,675 mm
d	384.175 mm
D	546.1 mm
T	193.675 mm
B	193.675 mm
$r_{1,2}$ - min.	3.3 mm
$r_{3,4}$ - min.	6.4 mm
Basic dynamic load rating - C	3470 kN
Basic static load rating - $C_0$	8300 kN
Fatigue load limit - $P_u$	640 kN
Comparative radial load rating - $C_F$	865 kN
Comparative axial load rating - $C_{Fa}$	278 kN
Thrust factor - K	1.76
Calculation factor - e	0.33
Calculation factor - $Y_1$	2
Calculation factor - $Y_2$	3
Calculation factor - $Y_0$	2
Mass bearing	166 kg
Design variant/feature	TDIT/Y2



## Bearing Driveshaft do Brasil

$d_1$	417 mm
$D_1$	484 mm
$r_{1,2}$ min.	3.3 mm
$r_{3,4}$ min.	6.4 mm
Basic dynamic load rating C	3724 kN
Basic static load rating $C_0$	8300 kN
Fatigue load limit $P_u$	640 kN
Calculation factor e	0.33
Calculation factor $Y_1$	2
Calculation factor $Y_2$	3
Calculation factor $Y_0$	2
Comparative radial load rating $C_F$	915 kN
Comparative axial load rating $C_{Fa}$	301 kN
Thrust factor K	1.76